



## **Mountney Steering Wheel – Product Recall.**

**Part number - 5232501**

**Supplier reference - 23SBLB**

**Reference -WEST271018 – Customer Advisory notice**

In line with company policy we are notifying you of a highlighted issue that has been brought to our attention. The issue concerns the Mountney classic steering wheel.

We currently at this moment in time have three reported issues which has escalated the situation to instigate product recall.

The issue has been narrowed down to wheels produced up until August 2017 by the supplier. However, it may be that wheels supplied by the factory after that time may still be affected due to stock supplies issued after the date.

The issue found relates to the outer rim fixing of the wheel to the centre hub pressing, around the thumb spat area. It is held to the rim using rivets. A customer has reported that the rivets have become loose causing the outer section of the rim to flex, which possibly over a period could become detached.

Working inline with DVSA guidelines we have contacted the supplier regarding the matter and are now in product recall status.

The areas circled in red on the images laid out below show where the outer rim is attached to the centre hub pressing. These are the areas of concern that can become loose.

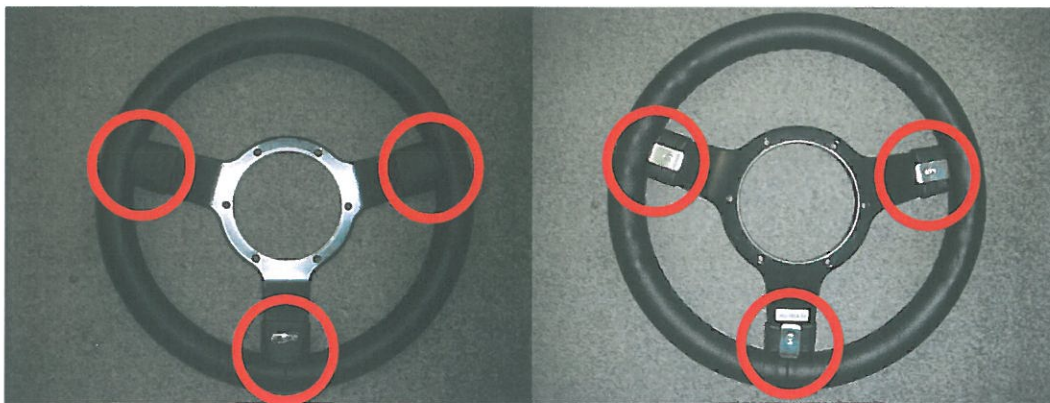



# Westfield Sportscars

Westfield Sportscars Ltd  
Unit 1 · Gibbons Industrial Park · Dudley Road · Kingswinford · West Midlands · DY6 8XF  
T: +44 (0)1384 400077 · F: (0)1384 288781 · E: info@westfield-sportscars.co.uk



We hereby give notice to any customer who has purchased the above product to contact the factory immediately so that the wheels can be returned to the supplier for rectification.

**UNDER NO CIRCUMSTANCES SHOULD THE VEHICLE BE USED IF ANY PLAY IS APPARENT IN THE AREAS HIGHLIGHTED ABOVE.**

Please complete the registration paperwork below with your full name, address, contact details and proof of purchase so We can arrange collection of the item for rectification. Alternatively complete the registration paperwork and return the item back to the factory directly if this is easier.

Name:

Address:

Contact number:

Account number:

Proof of Purchase:

Date of Registration:

You will be contacted by a member of our QA department once the rectification plan has been confirmed by the supplier and DVSA.

Westfield QA contact Andrew Meese - 01384 400077 E-mail - andrew.meese@westfield-sportscars.co.uk

Mark Walker

Group CTO Westfield Sportscars Ltd

